

Drng N° C 57

Type Wormwheel Hob Finisher

N° Gashes 8

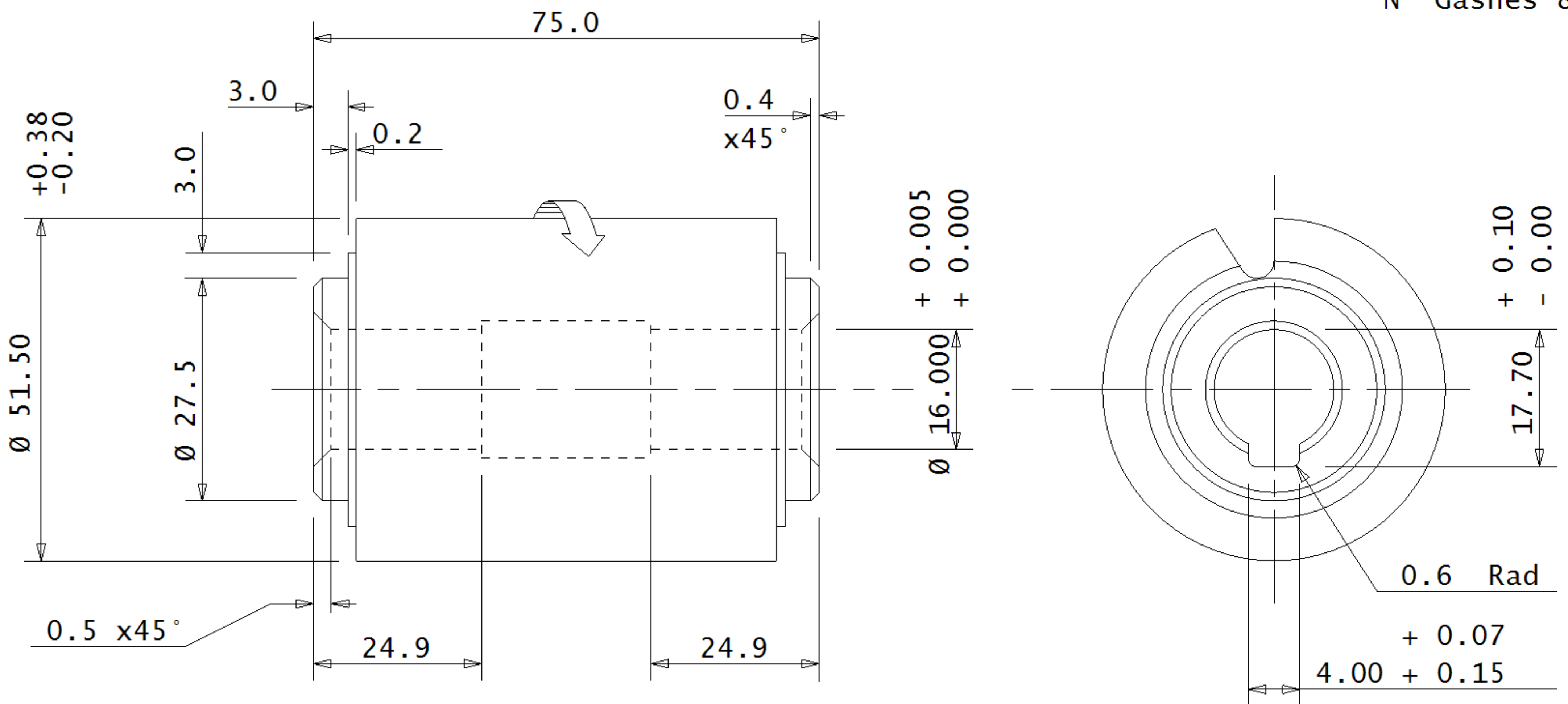

B1

Component Details
 Worm 3st 16° 41' 57" LA RH
 37.699 mm Lead
 48.000 mm OD
 40.000 mm PCD
 31.100 mm RD
 6.141 mm NTT
 'Involute Helicoid' ZI
 24.786 mm BCD
 64.166° BHA
 Wheel 31 T 82.000 mm C.Dist
 136.000 mm OD
 131.325 mm TD
 124.000 mm PCD
 114.425 mm RD
 0.113 mm Ax Backlash

Special Details

MARK

4 AX MOD 20° NPA
 TOPPING

LEAD = 37.4976

8.450 MM CD 15° 53' LA
 3 ST RH 25" GL

MADE IN ENGLAND

ACEDES / Matl Code

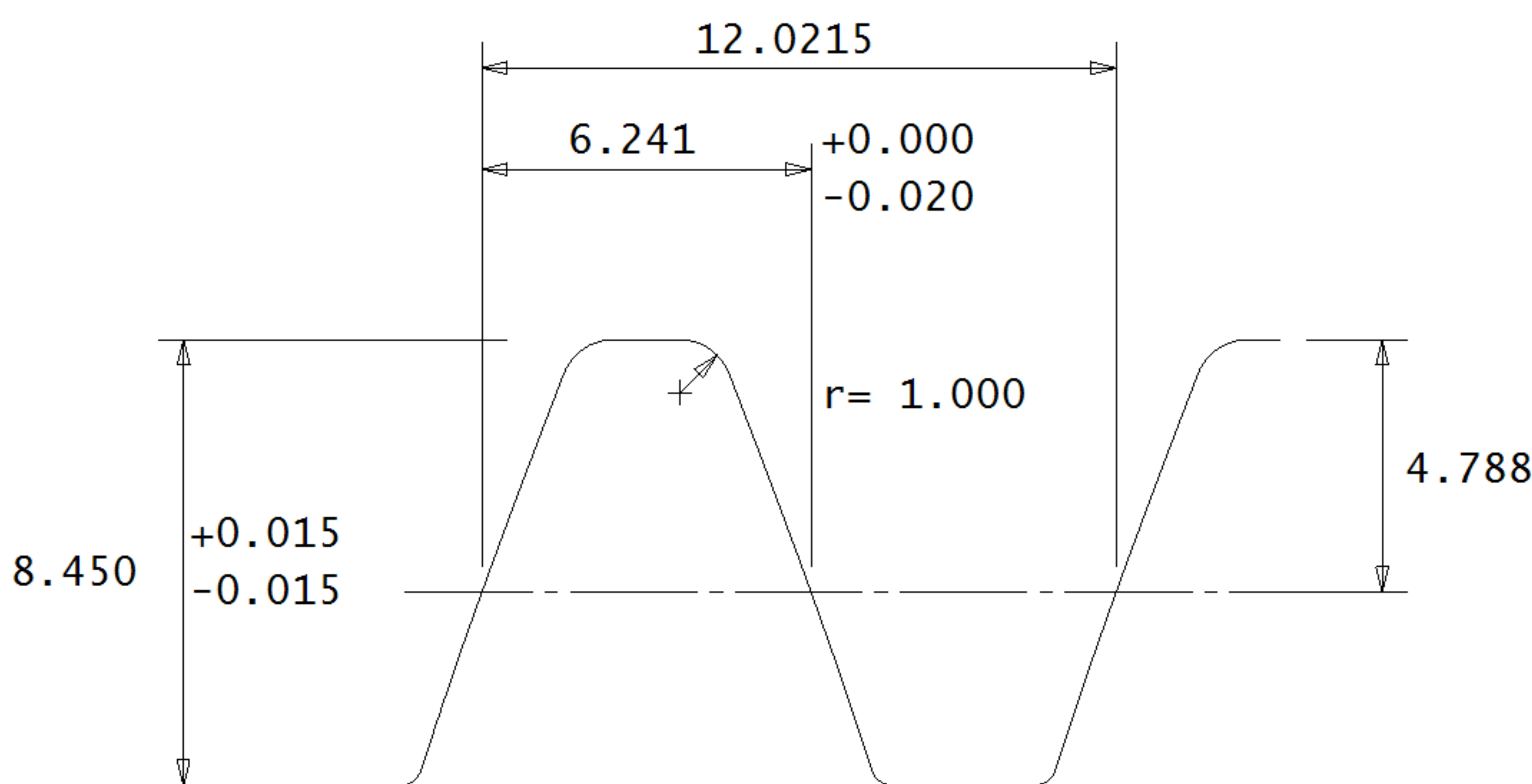

FOR :-
 QUALITY GRADE
 TOOL MATERIAL
 COATING TYPE
 HAND AND QUANTITY
 REFER TO CUSTOMERS ORDER
 OR ACCOMPANYING
 CORRESPONDANCE
 FOR UNTOLERANCED HOB
 DIMENSIONS REFER TO TD 7

For further information
 regarding this tool design
 please contact
 ACEDES Gear Tools
 at the address below.



Relief Cam 2.8 mm Lead = 37.4976
 Ground Relief
 Topping

NORMAL BASIC RACK

ACEDES GEAR TOOLS
 (a division of Furzeland Ltd.)

Newbury, Berkshire, RG14 2DE, England
 web:www.acedes.co.uk e-mail:sales@acedes.co.uk

© Copyright Furzeland Ltd 08/10/2013